

2504 MARINA GATE, TOWER III

Stunning, fully furnished 2 bdr with the city view,
Hermes design and premium materials.

FLOOR : 25

SQUARE : 132 SQM

VIEW : CITY VIEW

4 900 000 AED
\$1 343 000



Apartment Area	124.11 m ²	1335.91 ft ²
Balcony Area	9.00 m ²	96.88 ft ²
Total Area	133.11 m ²	1432.78 ft ²

2504

MARINA GATE TOWER 3

Stunning, fully furnished 2 bdr with the city view, unique design and premium materials.

Living Area : 123.50 sqm

Balcony Area : 8.56 sqm

Total Area : 132 sqm

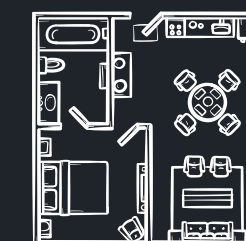

Selling with furniture,
technique and decor

TOUCH THE BOTTOM





PRIVATE APARTMENTS IN DUBAI MARINA

Jumeirah Living Marina Gate are located in the Dubai Marina district. Dubai Marina is the district in the western part of Dubai city. The construction of the district began only 20 years ago, but it has already become an iconic landmark. Main sights: The Walk at JBR, Dubai Marina Yacht Club.





HALL





LIVING ROOM





LIVING ROOM



LIVING ROOM



LIVING ROOM

A wide-angle photograph of a modern, open-plan living and dining area. On the left, a kitchen island with a white countertop and dark wood cabinets features a sink and a modern faucet. A wooden bar top extends from the island. Large floor-to-ceiling windows on the left and back walls offer a panoramic view of a city skyline with various high-rise buildings. The living room is furnished with a light-colored sectional sofa, two large, rounded armchairs, and a low, curved coffee table. A dining table with four chairs is visible in the background. The room is decorated with two framed abstract artworks on the wall, a track lighting system on the ceiling, and a multi-tiered circular pendant light over the seating area. The floor is made of light-colored wood planks. The overall atmosphere is bright and contemporary.

LIVING ROOM



LIVING ROOM



KITCHEN



KITCHEN

CORRIDOR





GUEST BEDROOM



GUEST BEDROOM



GUEST BEDROOM



GUEST BEDROOM

GUEST BATH





GUEST BATH





GUEST BATH



MASTER BEDROOM



MASTER BEDROOM

A modern master bedroom with a large open door leading to a living area. The room features a dark wood door, a large flat-screen TV mounted on a white wall, and a dark wood dresser with a silver car model on top. A green patterned bedspread is visible in the foreground. The living area in the background has a beige sofa, a small table, and a large window overlooking a city building.

MASTER BEDROOM



MASTER BATH



MASTER BATH

MASTER BATH





BALCONY



BALCONY



BALCONY





STYLISH LOBBY FOR RESIDENTS

The designers decorated the lobby in light beige shades. Placed futuristic lamps on the ceiling. In the center of the lobby there is a reception desk made of snow-white stone. The floor is tiled with beige stone.



24/7 CONCIERGE SERVICE

An attentive concierge will meet you in the hall. They will solve any household problems from meeting a courier, booking tickets or making restaurant reservations to delivering fresh flowers and food products.





BUSINESS CLASS SKYSCRAPER

Jumeirah Living Marina Gate offers cozy studios with space ranging from 570 sq ft and one-bedroom apartments with space from 740 sq ft. There are also more spacious 2-bedroom apartments with space from 1516 sq ft and 3-bedroom apartments with space from 2132 sq ft.





DUBAI MARINA WALK

Within walking distance from the apartment there is a walking area along the bay with yachts, surrounded by skyscrapers, shops, restaurants, salons and cafes.













SHADY LOUNGE AREAS

Rest in cozy hammocks and read your favorite book enjoying the fresh and cool air coming from the evergreen trees.



TWO 56-STOREY BUILDINGS

Architects designed a skyscraper consisting of two towers connected by a futuristic podium made of glass, brown panels and metal.